

THIS DOCUMENT CONTAINS DATA PROPRIETARY TO PROJECTS UNLIMITED, INC. ANY USE OR REPRODUCTION, IN ANY FORM, WITHOUT PRIOR WRITTEN PERMISSION OF PROJECTS UNLIMITED, INC. IS PROHIBITED.
 ©2005, Projects Unlimited Inc.

SPECIFICATIONS

PARAMETERS	VALUES	UNITS
RATED VOLTAGE (SQUARE WAVE)	5	Vp-p
OPERATING VOLTAGE RANGE	1 ~ 25	Vp-p
RATED CURRENT (MAX)	3	mA
CAPACITANCE	14000±30%	pF
MINIMUM SPL @ 10 CM	70	dBA
RESONANT FREQUENCY	4000±500	Hz
OPERATING TEMPERATURE	-40 ~ +120	°C
STORAGE TEMPERATURE	-40 ~ +120	°C
HOUSING MATERIAL	LCP	-
TERMINAL MATERIAL	Sn PLATED COPPER	-
WEIGHT	1	grams

REVISIONS			
LTR	DESCRIPTION	DATE	APPROVED
-	RELEASED FROM ENGINEERING	5/15/06	
A	REVISED CAPACITANCE TOLERANCE	12/4/06	R.W.
B	ADDED PART NUMBER TO PART	3/7/07	R.W.

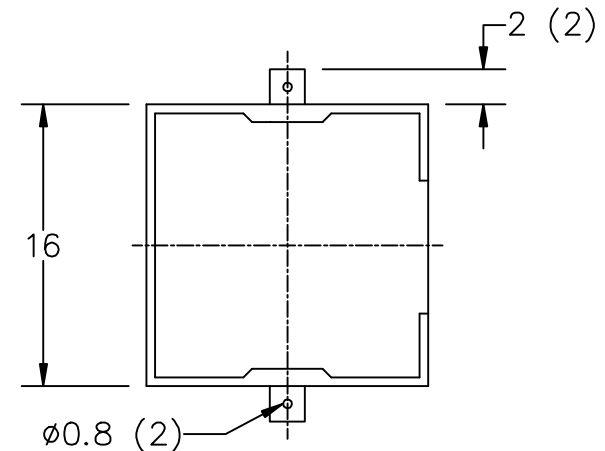
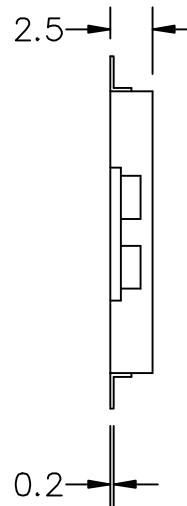
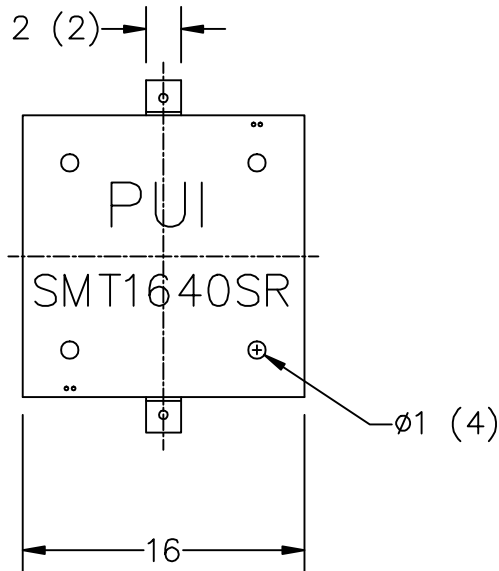

NOTES:

1. ALL DIMENSIONS ARE IN MILLIMETERS.
2. SPECIFICATION SUBJECT TO CHANGE OR WITHDRAWAL WITHOUT NOTICE.
3. THIS PART IS RoHS 2002/95/EC COMPLIANT.

FILE NAME
SMT-1640-S-R.DWG

UNLESS OTHERWISE SPECIFIED:
DIMENSIONS ARE IN MILLIMETERS, TOLERANCES ARE ± 0.5 AND ANGLES ARE $\pm 3^\circ$.

APPROVALS	DATE
DRAWN J.D.	5/06
CHECKED E.P.	5/06
APPROVED B.R.	5/06

projects®
unlimited Dayton, Ohio

TRANSDUCER

SIZE A DRAWING NO. SMT-1640-S-R

DO NOT SCALE DRAWING

SCALE: N.T.S.

SHEET 1 OF 1